

TEKNION CORPORATION
IN CANADA:
1150 FLINT ROAD
TORONTO, ONTARIO
M3J 2J5 CANADA
TEL 416.661.3370
FAX 416.661.4586

IN THE USA:
350 FELLOWSHIP ROAD
MT LAUREL, NEW JERSEY
08054 USA
TEL 877.TEKNION
FAX 856.552.5088

OTHER OFFICES LOCATED IN:
EUROPE
SOUTH AND CENTRAL AMERICA
MIDDLE EAST
ASIA
RUSSIA
FOR REGIONAL CONTACT
INFORMATION GO TO
www.teknion.com

TEKNION EMBRACES CHANGE AND ITS INNATE POSSIBILITIES. OUR CULTURE IS ONE OF INNOVATION. IN THAT SPIRIT, WE HAVE STEPPED FORWARD TO INTEGRATE SUSTAINABLE PRINCIPLES AND PRACTICES INTO THE DESIGN, MANUFACTURING AND MARKETING OF OUR PRODUCTS.

TEKNION PRODUCTS PERFORM INDEPENDENTLY AND IN CONCERT, COMBINING IN VIRTUALLY UNLIMITED CONFIGURATIONS. OUR PHILOSOPHY EMBRACES DESIGN AS ONE OF THE BEST TOOLS WE HAVE FOR REALIZING THE BENEFITS OF BUSINESS, WHILE ALSO STRIVING TO REACH SUSTAINABLE GOALS.

WE HAVE LEARNED FROM DESIGN THAT CHANGING A SINGLE DETAIL ALTERS THE WHOLE. EVERY INCH MAKES A DIFFERENCE. EVERY LEAP IS THE SUM OF MANY SMALL STEPS.

TEKNION CREATES FURNITURE THAT CONNECTS PEOPLE, TECHNOLOGY AND SPACES; INTEGRATED DESIGN WITH NEW POSSIBILITIES FOR A HEALTHY, PRODUCTIVE WORLD TOMORROW AND THE DAY AFTER.



Modular Cabinets

Modular Cabinets is a collection of storage cabinetry designed for business and institutional applications. Comprised of wall, base and storage units, Modular Cabinets provides a built-in custom look anywhere traditional millwork cabinetry is required.

QUALITY CONSTRUCTION

- Unique installation system uses wall-mounting rail and metal-to-metal cabinet connections, allowing freedom of change and ensuring structural integrity
- Wall cabinets are tested to hold 580 pounds on a 72-inch-wide wall rail
- Wall and base cabinets are available from 12 to 42 inches wide
- Base cabinets feature a 4-inch-high toe kick providing a comfortable work position when standing in front of the cabinet
- Base cabinet levelers offer a 3-inch leveling range adjustable from within the units once installed
- Cabinet cases are constructed of 11/16-inch-thick low-pressure laminate (45 pounds density) providing sturdy quality
- Solid door and drawer fronts are available in low- or high-pressure laminate and Teknion's Flintwood (reconstituted wood)
- Tempered glass doors are available in clear or frosted options
- Countertops and backsplashes are available with a special water-resistant construction for sink applications
- Designed for seismic zones/activity
- Included in Teknion's limited lifetime warranty



CABINETS: Solid Doors/Cases – Source Laminate, Storm White
Glass Doors – Frost with Foundation, Storm White frame
Handles – Mica, Platinum

COUNTERTOPS: Foundation Laminate, Storm White

TABLES: Surface – Seamless Color, Snapdragon
 Base – Mica, Platinum

ALTOS WALLS: Double Glazed Fascias – Frost/Clear
 Solid Fascias – Fascia Laminate, Storm White

SEATING: Nami Bar Stools, Shell – Storm White
 Frame – Chrome

Return on investment

- Modular Cabinets mounting rails fasten to wall studs, in contrast to millwork cabinets that require the wall to be blocked or reinforced which increases project costs
- Mounting rails also fasten to Teknion's Altos architectural walls, providing full integration of product lines
- Modular Cabinets' ability to be reconfigured and relocated offers a reduced cost of change and a cost-savings alternative to millwork
- For fiscal purposes, Modular Cabinets may be classified as either a construction cost or, in some jurisdictions, as office furniture allowing an accelerated depreciation

Environmental considerations

- Greenguard® certified for Indoor Air Quality
- Includes 94.7 percent recycled content
- Reusable cabinets result in reduction or elimination of natural resources, materials and demolition waste shipped to landfills – also helping companies achieve LEED-CI credits
- Ease of relocation and reconfiguration promote an environmentally responsible furniture alternative – again helping companies achieve LEED-CI credits
- Teknion offers FSC approved product as an option



CABINETS:
Doors/Cases – Source Laminate, Latte
Handles – Mica, Bronze

COUNTERTOPS:
Foundation Laminate, Evening Parchment

SEATING:
t-3 Stools, Upholstery – Fundamentals, Sudan

CABINETS:
Solid Doors – Flintwood, Pecan
Glass Doors – Frost with Mica, Platinum frame

Cases – Source Laminate, Storm White
Handles – Mica, Platinum

COUNTERTOPS:
Flintwood, Pecan

FREESTANDING SCREENS:
Frame – Mica, Platinum
Upper Elements – Frosted Glass
Base Elements – Source Laminate, Storm White

ALTOS WALLS:
Double Glazed Fascias – Frost/Clear
Solid Fascias – Flintwood, Pecan

SEATING:
Fitz, Upholstery – Gabriel Wool, Europost, Ecrú

Five handle styles offer aesthetic variation.

Shelves are adjustable every 1¼ inch and secure with a self-locking anti-tip support.

Wall cabinets with a microwave section provide above-surface mounted application.



Base cabinets provide a discreet waste bin/recycling center for kitchen applications.

Door hinges in options of 120 or 170 degrees (shown) offer optimal accessibility.

ADA-compliant units are available with or without doors for complete access below the surface.

Wall cabinets

standard wall cabinets
d 12", 15"
w 12"-48"
h 15", 24", 30", 36"

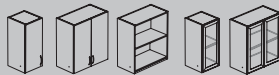

corner wall cabinets
d 12", 15"
w 24"-36"
h 24", 30", 36"

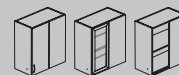

open wall cabinets
d 15"
w 12"-36"
h 30", 36"



open wall cabinets with doors
d 15"
w 12"-36"
h 30", 36"

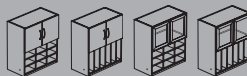

wall cabinets with microwave section
d 15"
w 24"-36"
h 30", 36"

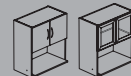

Base cabinets

standard base cabinets
d 24", 29"
w 12"-42"
h 33", 35"

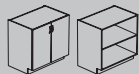

corner base cabinets
d 24", 29"
w 24"-36"
h 33", 35"



open base cabinets
d 24"
w 12"-36"
h 33", 35"



base cabinet for waste bin
d 24", 29"
w 18"
h 33", 35"



ADA sink base cabinets
d 24", 29"
w 33"-42"
h 33"

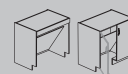

base cabinets
d 24", 29"
w 12"-36"
h 33", 35"

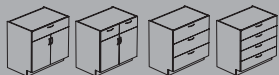

d 24", 29"
w 24"-42"
h 33", 35"



d 24", 29"
w 24"-36"
h 33", 35"



Storage cabinets

standard storage cabinets
d 24"
w 12"-36"
h 54", 72", 84"

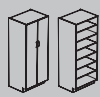

wardrobe storage cabinets
d 24"
w 24"-36"
h 54", 72", 84"



Accessories

wall support
w 72"

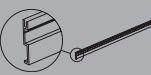

top filler
d 12"-24"
w 12"-48"
h 6", 12"



base filler
w 6"
h 33"-84"



side filler
w 6"
h 15"-48"



end panel for wall cabinet
d 12", 15"
h 15"-48"



countertop
d 25"-30"
w 12"-108"

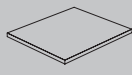

end gable
d 24", 29"
h 33", 35"



backsplash
w 12"-108"
h 4"

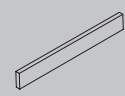

sidesplash
w 25", 30"
h 4"

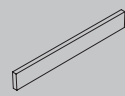

shelf
d 12"-24"
w 12"-42"

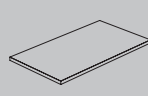

wall cabinet support kit for altos
h 15", 24", 30", 36"

